

RoseWood

Vision Plan **MOBILITY FORUM**

THURSDAY, February 19

6PM TO 8PM

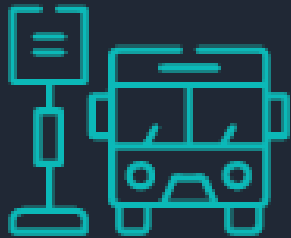

**TRANSIT
SERVICE**



**ACTIVE
TRANSPORTATION**



**TRANSIT-ORIENTED
DEVELOPMENT**

Regional Mobility

CONNECTIONS

- San Gabriel Mtns > Pacific Ocean
- Metro Foothill Gold Line
- Metro Silver Line BRT
- Foothill Silver Streak BRT
- Metrolink SBL, RSL, IEOC & OCL
- Amtrak Pacific Surfliner
- Amtrak Southwest Chief
- Whittier Narrows Park
- Metro Eastside Gold Line
- Future High-Speed Rail
- Metro Green Line
- Kaiser Permanente Medical Center
- Metro West Santa Ana Branch
- Long Beach Airport
- Cal State Long Beach
- LBC VA Medical Center



28
Total miles
North-South



13
Cities /
Communities

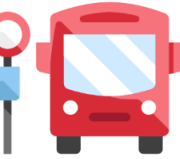

13
Major transit
line connections



8k & 12k
Daily boardings
@ 50% & 100%
dedicated bus lanes



39k & 53k
VMT reduction
@ 50% & 100%
dedicated bus lanes



- Northern segment
- 9.6 miles
- 7 cities include:

East Pasadena, East San Gabriel, Temple City, Rosemead, El Monte, South El Monte & Whittier Narrows

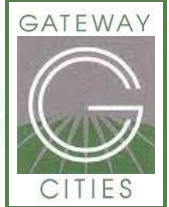

- Southern segment
- 16.7 miles
- 6 cities include:

Pico Rivera, Downey, Bellflower, Paramount, Lakewood, Long Beach

-  City of Pico Rivera
-  Existing Metro LRT Lines
-  Planned Metro LRT Lines
-  Commuter Rail Corridor
-  Rosemead/Lakewood Blvd.

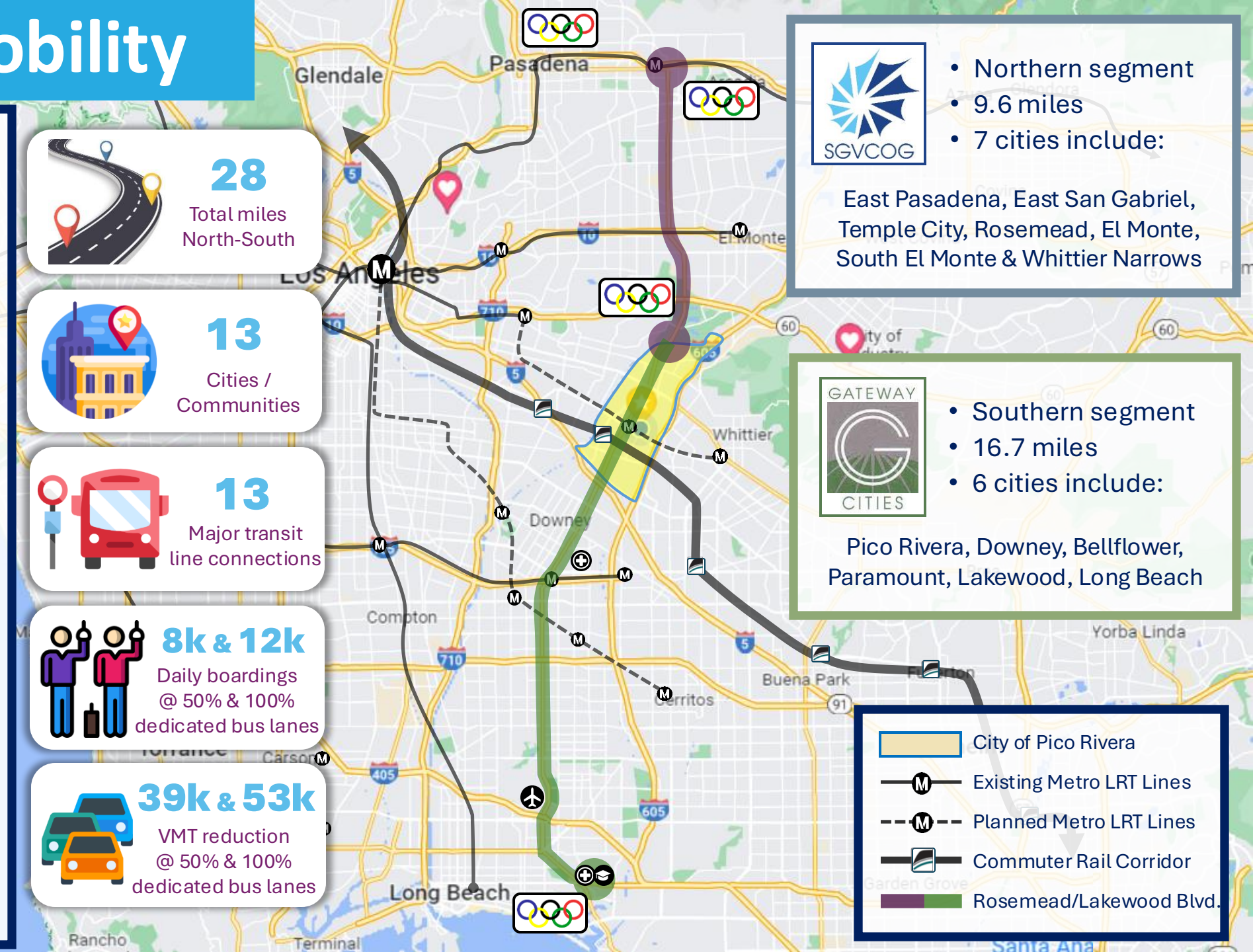

Transit



Service: Safety, Frequency, Reliability, Convenience



Infrastructure & Amenities: Signage, Shelters, Signal Priority, Lane Configuration, Benches, etc.

ATP & 1st/Last Mile



Safety, Access, Connected & Integrated



Infrastructure & Amenities: Landscaping, Beautification, bike parking, repair stations, etc.

Transit-Oriented Community Development

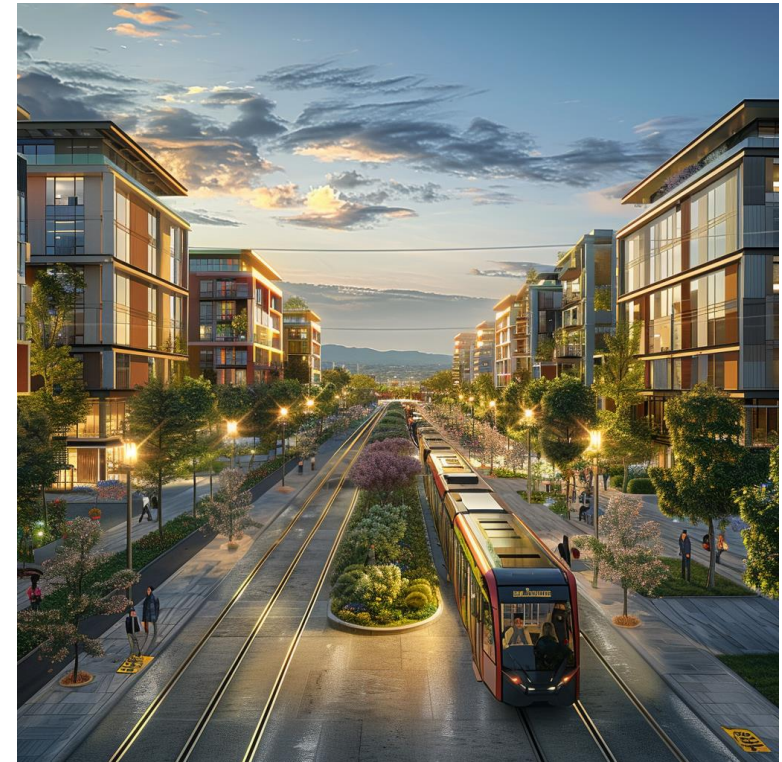

Moderate-to-High Density; Mixed-Use Development; Mixed-Income Housing; Reduced Vehicle Parking; Cultural Placemaking; Parks & Open Space; Compact

Project Timeline:

April 2025 - June 2026

COMMUNITY ENGAGEMENT AND MEETING WITH CITIES AND AGENCIES

DEVELOPMENT OF THE VISION PLAN

PUBLIC REVIEW
OF VISION PLAN

Current ridership

- Metro Line 266: 5,500 weekday riders

Travel time: Pico Rivera to Long Beach VA

- About 1 hr 45 min, with two bus transfers

Current service levels

- **Metro Line 266:** Every 20 minutes weekdays and every 30 minutes on weekends
- **LBT Route 111:** Every 60 minutes weekdays and weekends



Improved Connectivity with Long Beach



Strong travel demand: between Long Beach and the Gateway Cities.

Stop Spacing Options

Bus stops spaced ¼ mile apart: slower trips for longer-distance riders.



Increased stop spacing: reduce travel times when paired with upgrades (dedicated bus lanes).

Frequent Service & Bus Speed Improvements



~15 minutes or better



Existing transit options: infrequent and require transfers between LBT and Metro.



Existing transit options: infrequent and require transfers between LBT and Metro.

SHORT-TERM IMPROVEMENTS



Early Stop Improvements: Bus Rapid Transit type shelter, seating, trash receptacles, e-paper displays, and informational kiosks



Express Bus Service

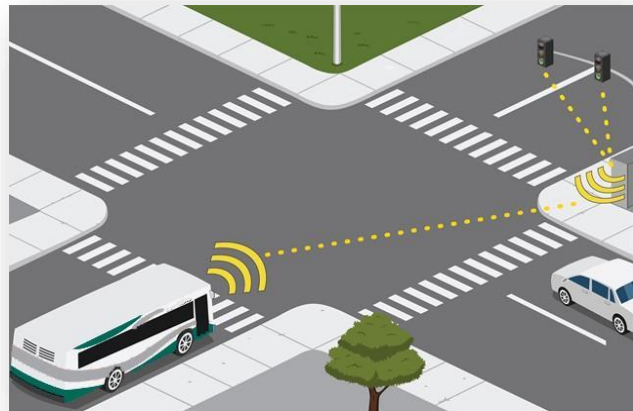

Transit Signal Prioritization

LONG-TERM IMPROVEMENTS

Unified Vision for the Full Corridor



Dedicated Bus and/or Bike Lanes Where Feasible
Safe, Frequent & Reliable Service (Bus Rapid Transit)
Integrated Transit-Oriented Community Development
More Sustainable, Climate Resilient, and Economically Vibrant Corridor
Phased-Implementation Strategy

BEVERLY RD to WHITTIER BLVD

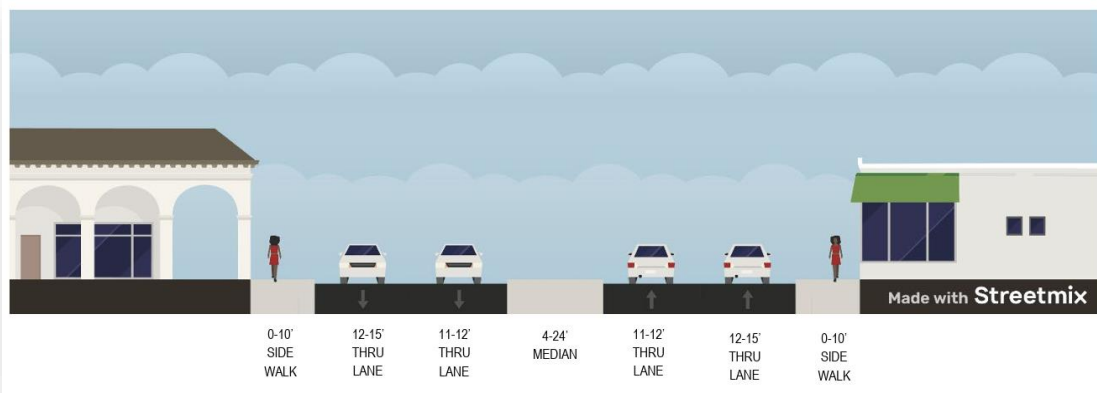

EXISTING

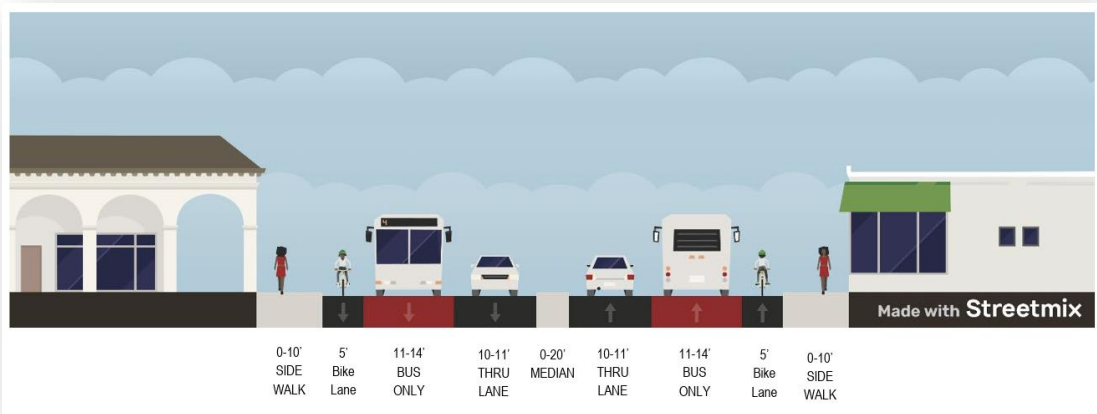

PROPOSED

One thru lane can be eliminated to provide a bus only lane

ROSEMEAD / WHITTIER BLVD

Pico Rivera

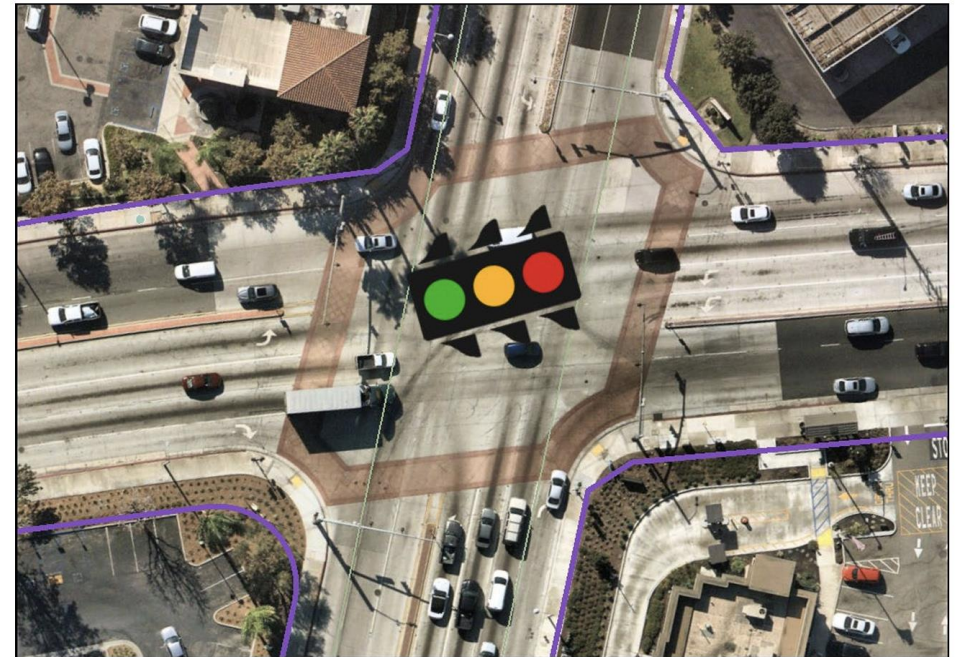

SLAUSON AVE to TELEGRAPH RD

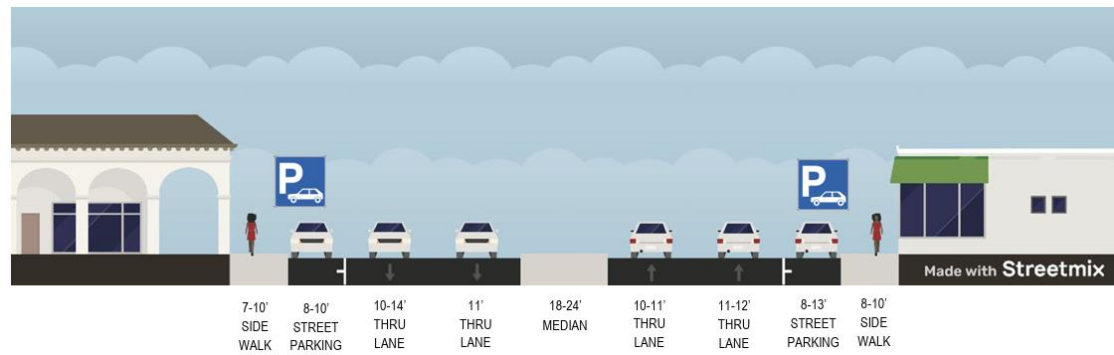

EXISTING

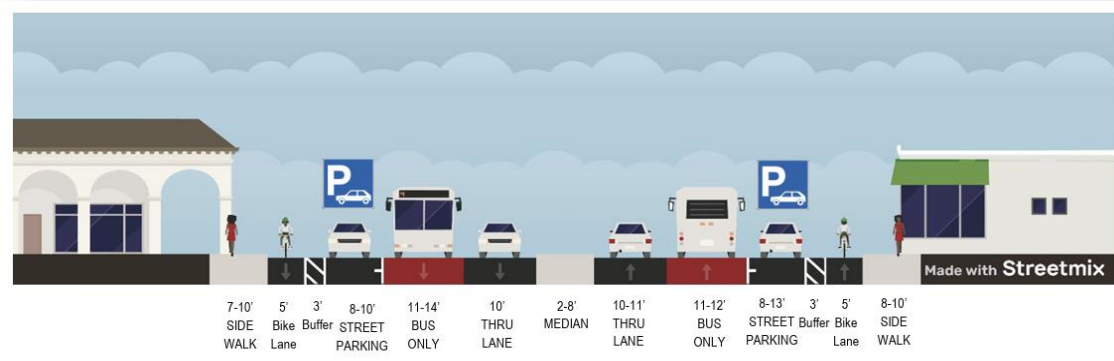

PROPOSED

One thru lane can be eliminated to provide a bus only lane.
Street Parking could be utilized to make Side-Running with BulbOut.

LAKWOOD / TELEGRAPH

Downey

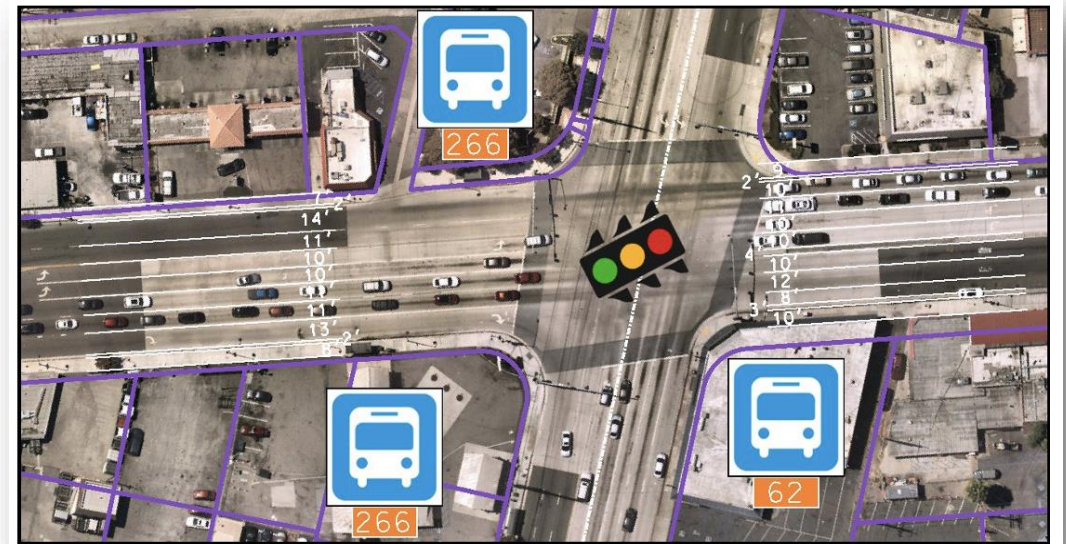

What Is Being Proposed?

- Strategic redevelopment of key sites along the corridor.
- Creation of:
 - More housing options
 - Mixed-use spaces (shops + offices + homes)
 - Community-friendly public areas
- Increased residential density near transit stops to make transit more accessible and efficient.

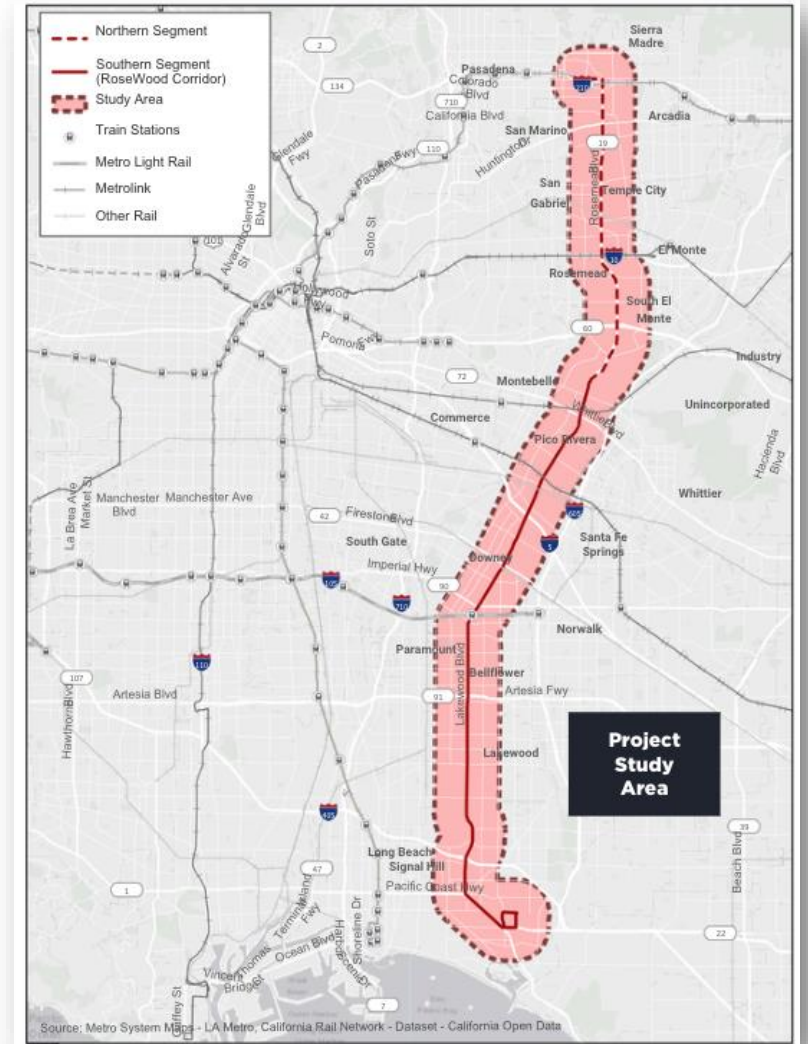



Active Transportation Master Plan

PICO RIVERA

ACTIVE TRANSPORTATION MASTER PLAN



Project Timeline



APR – AUG 2025

Existing conditions study and begin community engagement



SEPT – JAN 2026

Develop and prioritize actions with community input



FEB – APRIL 2026

Release Proposed Network
Draft ATMP for community feedback



MAY – AUG 2026

Revise and finalize plan

Existing Network

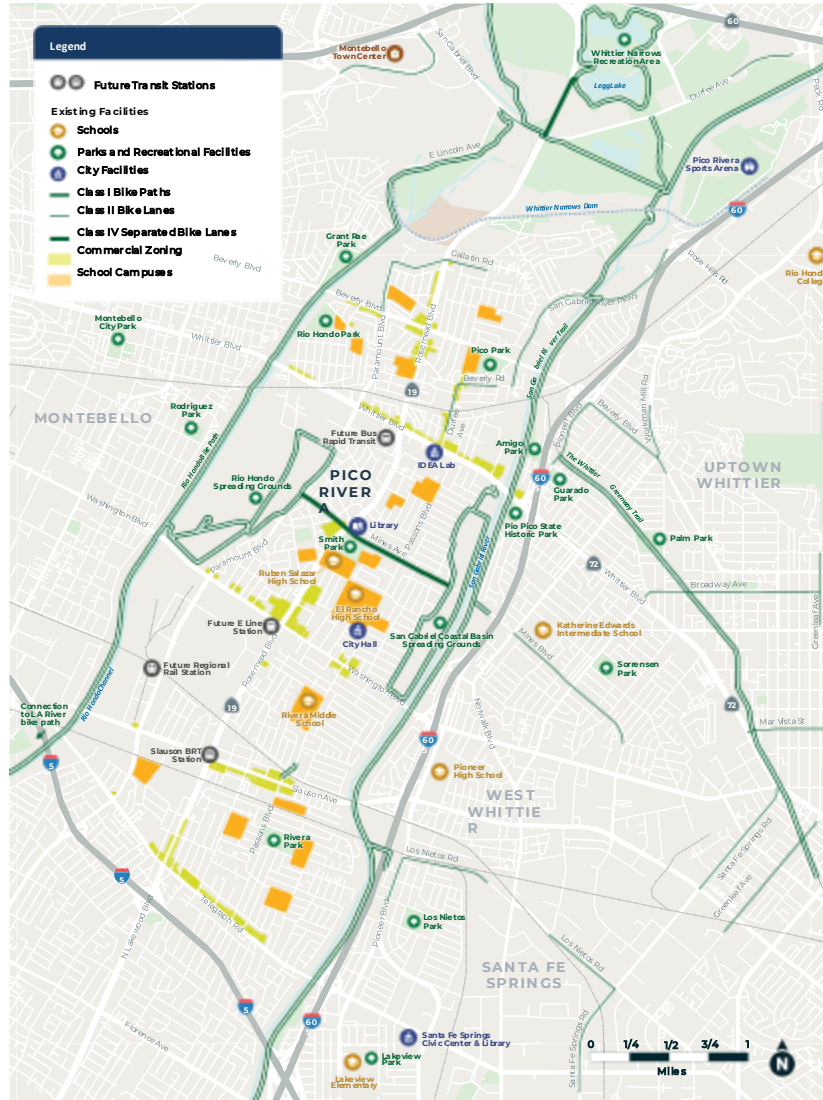

Proposed Network



JOIN US ON FREE BIKE RIDES!



PICO RIVERA FREE COMMUNITY BIKE RIDES

JOIN US FOR FREE MONTHLY BIKE RIDES STARTING IN FEBRUARY!

- Riders should be comfortable riding ~10 miles at 10 mph
- Helmets required for youth under 18, recommended for adults
- Trailers and passenger seats allowed
- No bikes with training wheels, please
- Class 1, 2, and 3 E-bikes are welcome

Sat. Feb. 21, 2026 9:30 am - 12:30 pm	Explore Mines Avenue Ride <i>Meet at Smith Park</i>
Sat. Mar. 21, 2026 9:30 am - 12:30 pm	Greenways Ride <i>Meet at Smith Park</i>
Sat. Apr. 18, 2026 9:30 am - 12:30 pm	History Ride <i>Meet at Smith Park</i>
Sat. May 16, 2026 9:30 am - 12:30 pm	Ice Cream Ride <i>Meet at Smith Park</i>



Pre-registration is required - space is limited.
Register at bit.ly/PR_BikeRides or
scan the QR code!
Questions? Email Colin@GoDayOne.org

Fehr & Peers



**FOLLOW ALONG BY
VISITING OUR
WEBPAGE!**

Visit our website:
<https://www.pico-rivera.org/active-transportation-master-plan/>

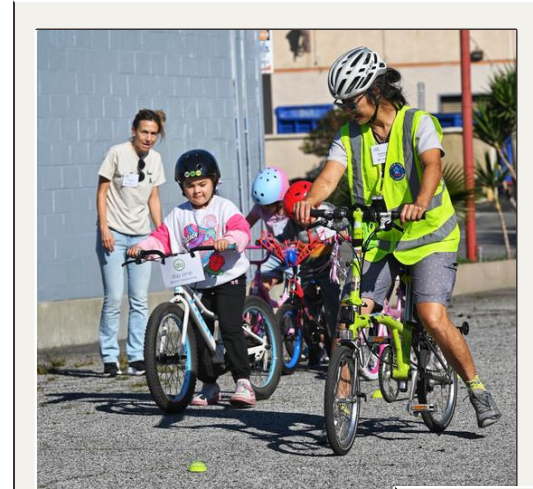

Bus C

Bus Corridor Alternatives



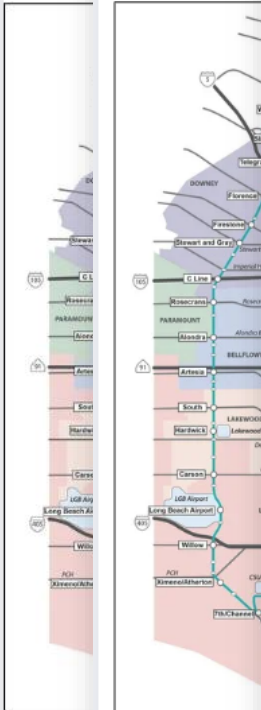

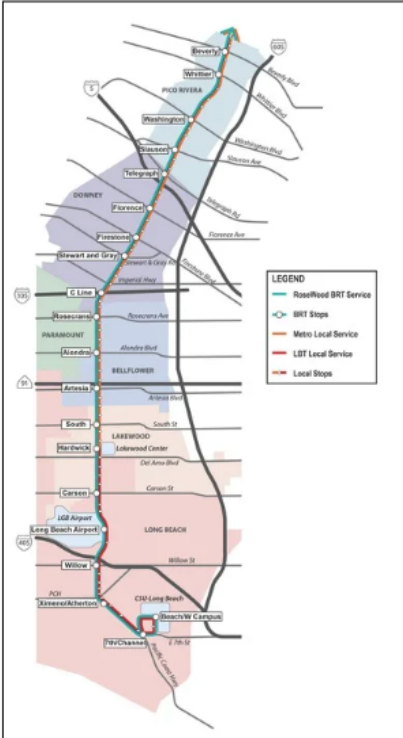

LEGEND

- RoseWood BRT Service
- BRT Stops
- Metro Local Service
- LBT Local Service
- Local Stops

Full BRT Service Alternative #5

Service:

- Single service provider
- 15-minute headways
- Longer stop spacing (approximately 1 mile) for faster travel times
- Underlying Metro and LBT 30-minute local service

Infrastructure:

- Bus-only lanes on full corridor (100%)
- Transit Signal Priority at key intersections
- Eight curb extensions at major stops

	Low	High
Transit Access	← ● →	
Speed Improvements	← ● →	
Transfers	← ● →	
Cost	← ● →	
Ease of implementation	← ● →	

Visit the website to learn more:
www.rosewoodcorridor.com



For more information, contact
Javier Hernandez at
jhernandez@pico-rivera.org

Help Us Help You...

ONE

Visit booths, ask questions & provide input



TRANSIT SERVICE

TWO

Join a small group discussion



ACTIVE TRANSPORTATION

THREE

Spread the word with family, friends & neighbors



TRANSIT-ORIENTED DEVELOPMENT



JAVIER HERNANDEZ

Director of Innovation & Communications

jhernandez@pico-rivera.org